



# Guarascreed Mastic Asphalt

## Detail Sheet

### GUARASCREED

Guarascreed is a proprietary mastic asphalt screed manufactured using bitumen, fillers and graded aggregate as well as where appropriate additives to suit the required end usage.

### Screed Design

Guarascreed will provide a substantial and continuous support to the subsequent mastic asphalt application and can be purpose designed for applications ranging from roofing, both traditional and protected membrane, balconies and access walkways through to car or lorry deck specifications.

*NB. The requirement for a separate vapour control layer is avoided where a warm roof specification using an asphalt screed is specified.*

Whilst Guarascreed for use in an elevated car deck specification would be designed to have a compressive strength as good as that of concrete of 20 N/mm<sup>2</sup> the product can be modified to provide similar properties in a lightweight format where dead weight is an important consideration. The product can also be modified for use in chemically hostile environments to provide falls under specialist flooring grades to assist in the collection and containment of aggressive liquids.

### Minimum Thicknesses

Guarascreed can be specified in the majority of cases falling to minimum thicknesses where traditional sand/cement and lightweight screeds require a minimum thickness of 50mm.

### Temporary Waterproofing

In addition to replacing a wet trade Guarascreed can be trafficked when cooled to ambient temperature and provide temporary waterproofing to the structure to allow internal trades to progress.

### Fast Track

There is no extended drying or curing time allowing fast track techniques to be employed resulting in earlier contract completion.

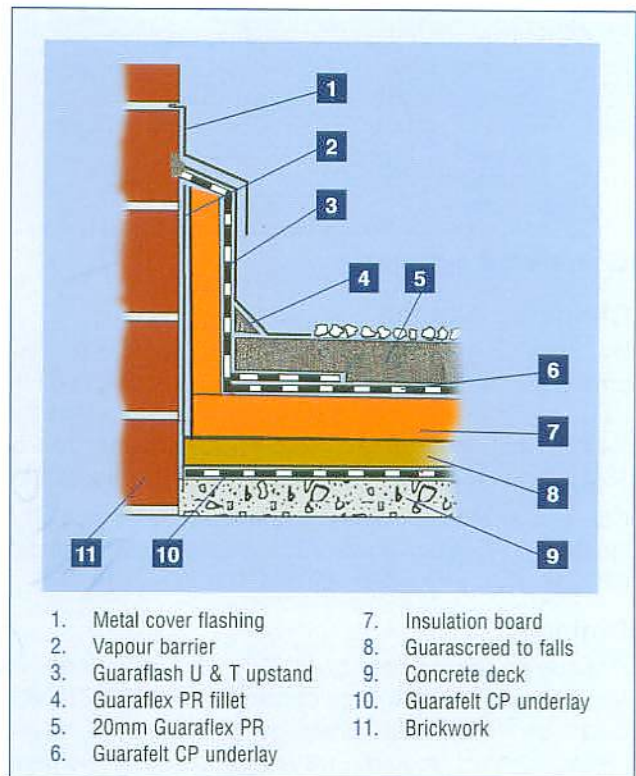

**Proprietary System 2R<sup>(1)</sup> – Concrete deck**

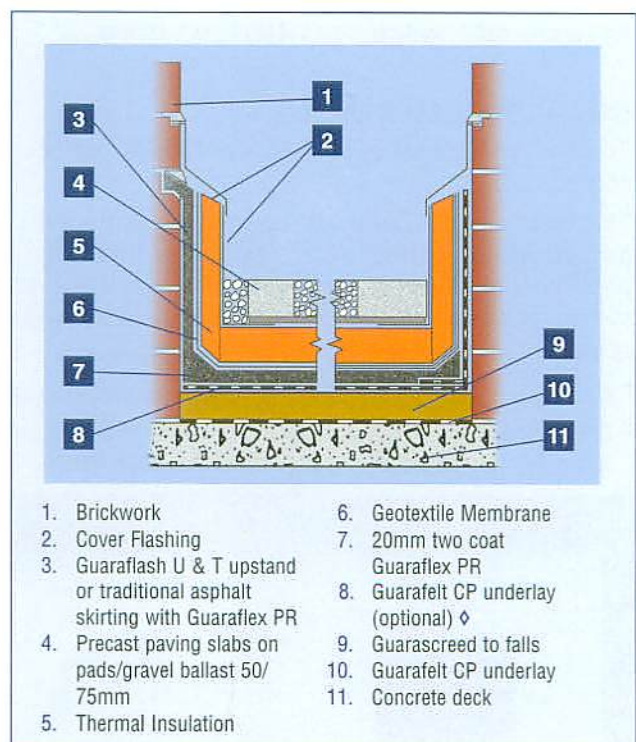

**Proprietary System 2  
Super inverted insulated roof/patio specification**

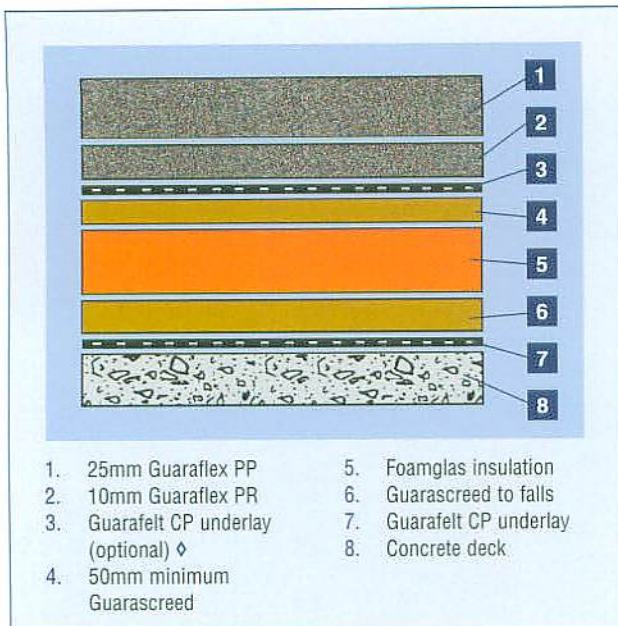

**Guaraflex P system 9<sup>(1)</sup>**

### Choosing Asphalt

By choosing asphalt roofing in a warm roof configuration, adequate drainage is achieved by using a minimum finished fall of 1:80 whilst other flat roofing materials usually require a minimum fall of 1:60 resulting in direct additional construction costs.

For protected membrane installations using the Guaraflex R system on asphalt screed over Guarafelt CP underlay, a finished fall of 1:100 is acceptable.

### Drainage

Drainage should be provided and designed in accordance with the requirements of BS 6367:1983, Code of Practice for drainage of roofs and paved areas. Outlets should always be located at the level of the waterproof membrane and should be suitable for use in conjunction with mastic asphalt.

*NB. Normally outlets would be provided at 10 metre centres.*

### GUARASCREED STABILITY

For the assessment of the Indirect Tensile Stiffness Modulus test (ITSM), cores were tested in accordance with BS DD213.

The results of the ISTM testing gave a range of results from 7482 to 8762 MPa. For a highways bituminous pavement, values above 3000 MPa are often taken as being good, and values below 1500 - 1000 MPa being poor. With results showing that the material achieved values at least twice as high as the 3000 MPa threshold, the material was classed as having a good stiffness. Stiffness helps in the resistance to deformation, which is an important factor with flexible materials.

\* Compressive strength testing was undertaken in accordance with BS 1881-120 1983 (test method modified).

♦ Where the waterproofing specification is laid on an asphalt screed/asphalt protection layer the inclusion of the upper Guarafelt CP underlay is at the discretion of the asphalt contractor.

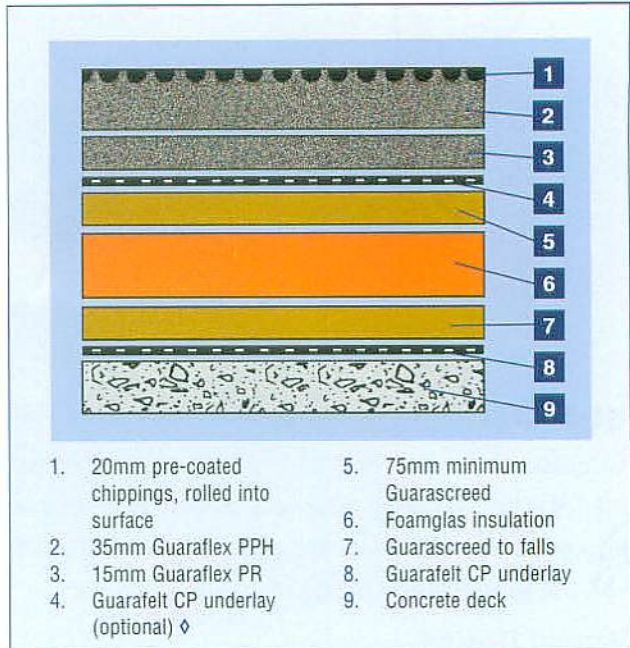

**Guaraflex P system 10<sup>(1)</sup>**

## GUARANTEED ASPHALT MANUFACTURING DIVISION

The company operates under a Quality Assurance Scheme to BS EN ISO 9002:1994 producing both British Standard and high performance polymer grades for a wide range of applications.

## TECHNICAL SUPPORT AND SPECIFICATION SERVICE

Guaranteed Asphalt operates a comprehensive Technical and Specification Service for Architects, Specifiers and Contractors. Our team of Technical Advisors will consult and advise on specific requirements to your project design and provide detailed specifications tailored to individual projects.

*For further information please contact Guaranteed Technical Services on 020 7732 7781.*



**GUARANTEED ASPHALT**

Guaranteed Asphalt Manufacturing Division  
 Earlstree Industrial Estate Princeswood Road Corby Northants NN17 4AP  
 t: 01536 260995 f: 01536 262381 e: gacorby@talk21.com w: guaranteedasphalt.com

